

PCS & IMT Omni Antenna

1750 ~ 2170 MHz / 4 dBi

PI-ST-04-T0

i. Electrical Specification

Frequency Range	1750 ~ 2170 MHz
Polarization	Omni
Band Width	420 MHz
Gain	≥ 3.5 dBi
Beam Azimuth	Omni
Beam Elevation	8 Type
F-B ratio	-
IMD (2x30dBm)	-153 dBc
VSWR	≤ 1 : 1.5
Impedance	50 Ω
Maximum input power	200 W



ii. Mechanical Specification

Radom Dimension (D x H)	Ø20 x 215 mm
Weight (Include bracket)	≤ 500 g
Connector Type	N – Female
Withstand Wind Pressure	60 m/sec
Radome Material	FRP
Radome Color	White
Temperature	-40 °C ~ 70 °C
Packing Size (H x W x D)	-
Packing Weight	-

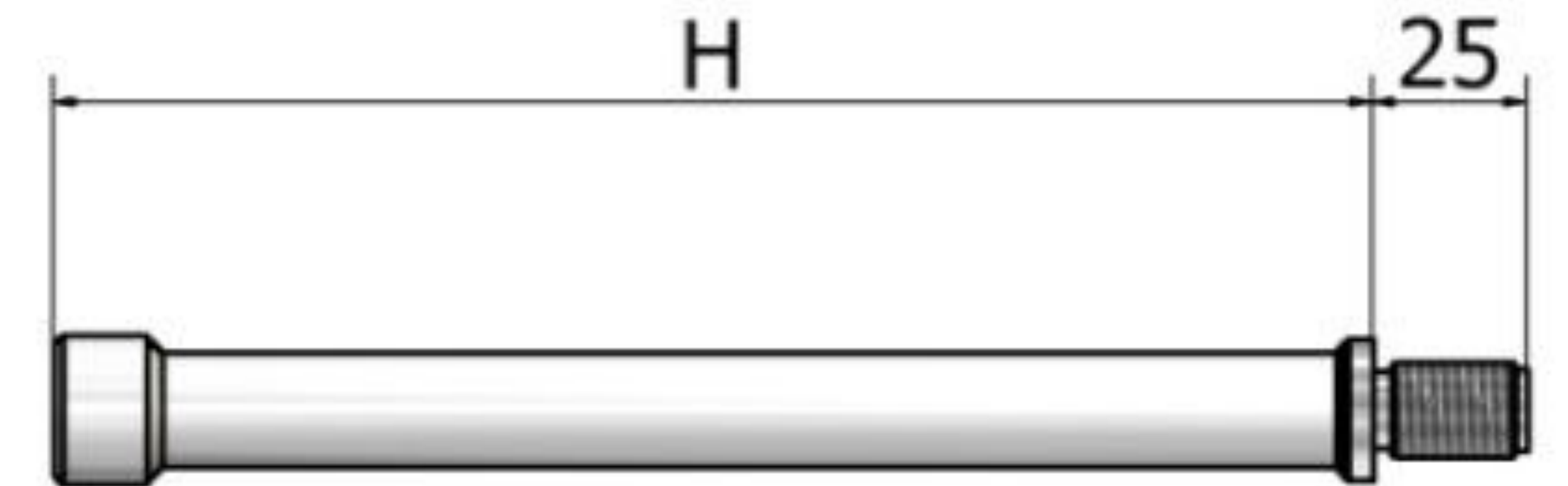

iii. Radiation Pattern

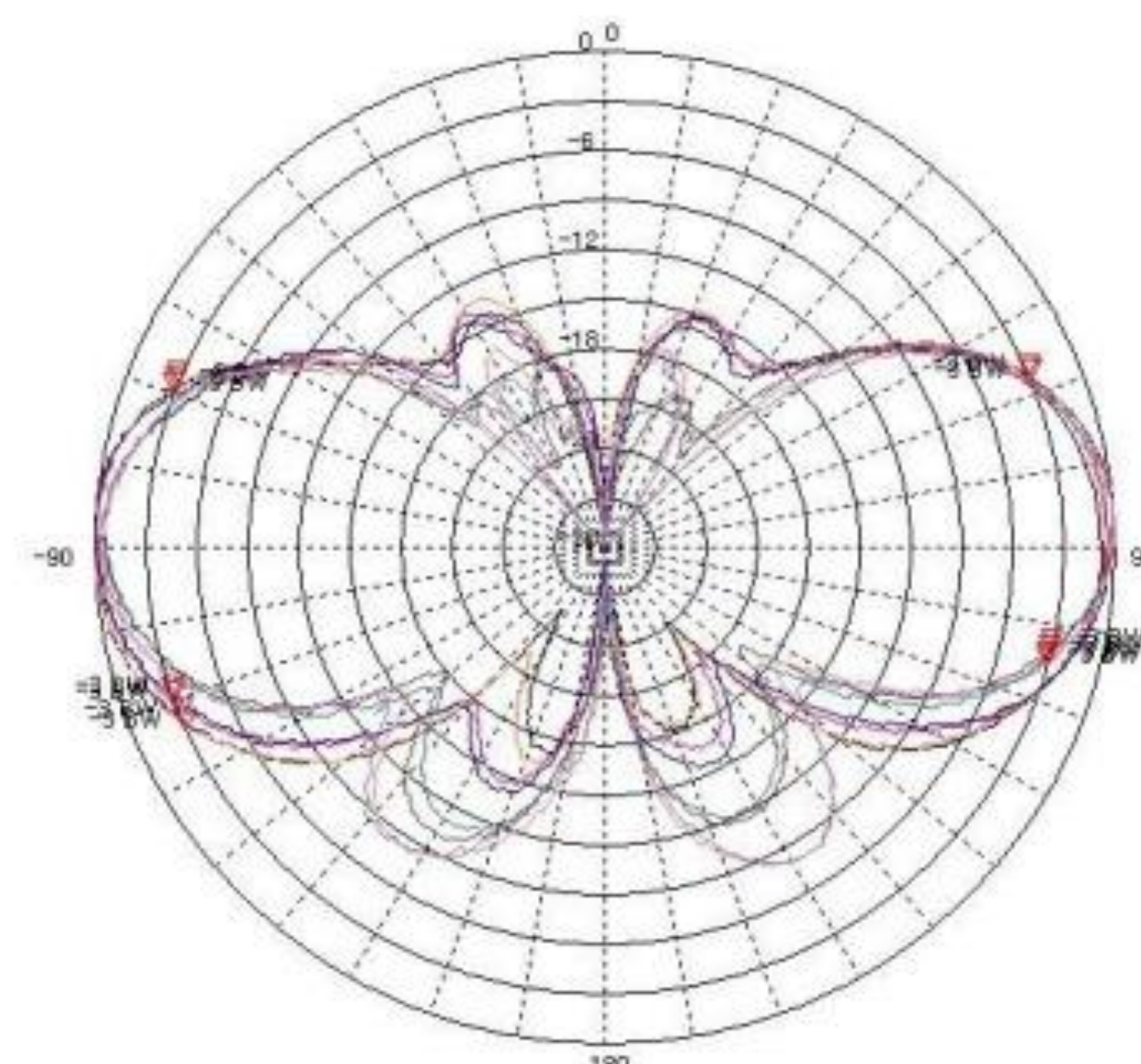

Vertical Pattern